

FOR9T AURA

WARNING LIGHT / POS. LIGHT

WIRING INSTRUCTIONS

- **RED: + WARNING LIGHT**
- **BLACK: - NEGATIVE**
- **WHITE: + POSITION LIGHT**
- **YELLOW: PATTERN SELECTION & SYNC FUNC. (TO + VDC)**
- **GREY: SIGNAL CABLE FOR ASYNC FUNC.***

TYPE OF CONNECTION: 2.5m Loose cable

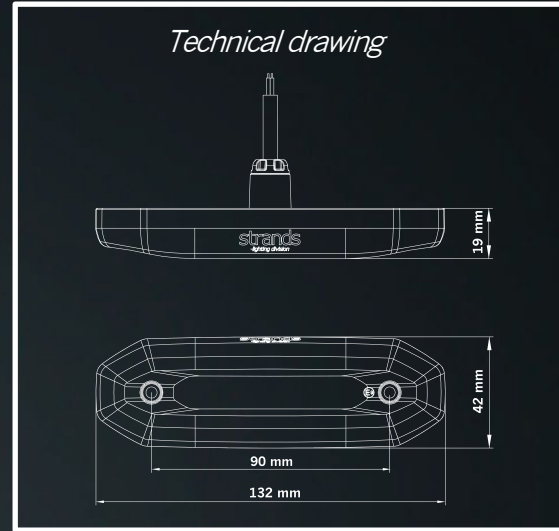

ADDITIONAL INFORMATION

Flash Pattern Selection and Synchronization

- Next Pattern: Apply the yellow wire to the positive (+) terminal for 0.1 to 1 second and then disconnect.
- Previous Pattern: To revert to the previous flash pattern, Apply the yellow wire to the positive (+) terminal for 3 to 5 seconds and then disconnect.
- Reset to First Pattern: To reset to the default factory pattern, Apply the yellow wire to the positive (+) terminal for more than 5 seconds and then disconnect.

Synchronization: To synchronize multiple warning lights, connect all yellow wires together. (Just tie up together)

Asynchronous Operation (Alternating Flash)

To achieve an asynchronous (alternating) flash pattern between your lights, please follow these instructions using the Grey and Yellow wires:

Ensure that all synchronization (yellow) wires remain connected together as per the standard synchronization instructions.

Asynchronous Configuration: Connect the grey wires of specific lights to the positive (+) terminal, while leaving the grey wires of the remaining lights disconnected.

Example: If you have six lights and wish for three of them to flash asynchronously (alternating) with the others, connect only the grey wires of those three specific lights to the positive pole. The grey wires of the remaining three lights should remain disconnected.

Nr.	Patterns list
1	Double flash(ECE R65 Class2)-by day
2	Double flash-by night
3	Double flash-Slow
4	Single flash
5	Single flash-Slow
6	Tripple flash
7	Quad flash-Fast
8	Quad flash-Slow
9	Octa flash-Fast
10	Octa flash-Slow
11	Twelve flash
12	Sixteen flash
13	Single flash-split
14	Double flash-split
15	Quad flash-split
16	Octa flash -split
17	Single flash -split accelerate
18	Double flash-split accelerate
19	SOS flash
20	Steady on

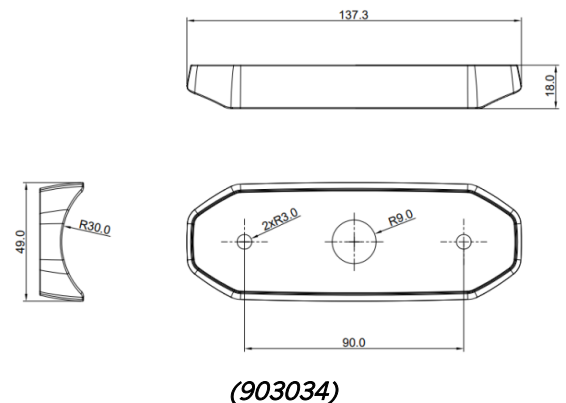

INCLUDED IN PACKAGE:

- *Screws: 2 pcs M4 bolts, 2 pcs M3.5 Self tap screws*
- *Nuts: 2 pcs M4*
- *Washers: 2 pcs M4*

- *Flat silicon pad: Yes*

- *Cable specification: Red/Black/White/Yellow/Grey 0.5mm²*

- *CURVED GASKET FOR MOUNTING ON BAR, SOLD SEPARATELY. PART NO. 903034.*

READ ALL THE INSTRUCTIONS AND STUDY THE DIAGRAMS BEFORE INSTALLING NEW LIGHT!

LEGAL MOUNTING

- Please check state and local laws for proper usage and mounting. Strands will not be responsible for products mounted incorrectly or in violation of local laws (e.g., ECE R48 regulation for the EU)

PRODUCT CARE

- Clean the product with lukewarm water and an alkaline degreaser. Avoid strong chemicals; rinse immediately if exposed. Do not use a pressure washer for cleaning.
- Take care if your light has a breather. Ensure it is protected against rain and dust, especially if it has a sticker breather. Damage to the breather due to incorrect installation will void the warranty.
- Internal moisture is normal and will dissipate through the breather vent after several days of use.
- We do not recommend painting the product housing. If paint is still applied, please ensure the breather is protected and an oven is not used for curing the paint. Otherwise, the warranty might be void.

INSTALLATION

- Ensure power is turned off during installation.
- Do not cut the connector cable to less than 50 cm. If the original cable is already shorter than 50 cm, leave it as is. Otherwise, the warranty will be void.
- Make sure to use only the correct accessories included in the package. Installation errors may void the warranty.
- Tighten screws, washers, and nuts to prevent them from loosening or chafing. Do not overtighten screws to avoid damaging the product's protective components.
- Use a watertight solution for wiring connections.

WARNING!

- For safe operation, use only the voltage specified in the product description. This light becomes hot under continuous use. Do not remove or touch the casing for at least 30 minutes after turning the lamp off



Contact us if you need support: support@strands.se or +46(0)320-450450
Please also refer to the FAQ section on our website for more information.

www.strandseurope.com

